

Care & Maintenance:

- **WATER WILL DAMAGE THE MT SONIC GROOM.** Do not use the unit in the shower, near water, or in a damp room.
- **DO NOT RINSE THE HEAD UNDER WATER!** To clean the head, use the brush that is included in the package. Make sure the unit is turned off.
- MT Sonic Groom should be switched off and stored in a cool dry place when not in use.
- For best performance, it is NOT recommended to use the MT Sonic Groom while it is charging.

MICROFOIL SHAVER MAINTENANCE

To maintain optimal performance of the Microfoil Shaver, from time to time clippings trapped in the head may need to be cleaned out. The Microfoil Shaver is designed for easy removal and may be easily cleaned by removing the head from the MT Sonic Groom, then gently tapping the bottom of the head against a hard surface, such as a sink. The brush included with the MT Sonic Groom may be used to wipe out any remaining clippings. Compressed air, such as a computer duster, may also be used to blow away the clippings from the Microfoil Shaver.

The main body of the MT Sonic Groom underneath the head should also be brushed or blown clean any time the head is cleaned or changed.

TOUCH ACTIVATED TRIMMER HEAD MAINTENANCE

The performance of the touch activated Trimmer Head may be kept at optimal level with regular cleaning (as described above) and lubrication of the touch activated Trimmer Head. To lubricate the touch activated Trimmer Head, after cleaning, apply a drop or two of mineral oil (or baby oil) to the front edge.

GROOMING GUIDE ATTACHMENT MAINTENANCE

Use cleaning brush to remove excess hair. Rinse Grooming Guide attachment under cool water. Allow to fully dry before reattaching to unit.

Warning:

- Keep out of reach of children.
- Exercise caution when using around eyes.
- The MT Sonic Groom contains a Lithium ion battery. DO NOT DISPOSE OF IN FIRE.

Usage for Face & Body:

- Face
- Shoulders
- Sideburns
- Back
- Neck
- Arms
- Chest
- Legs

For hard to reach and sensitive areas

This device complies with part 15 of the FCC Rules. Operation is subject to the following two conditions: (1) this device may not cause harmful interference, and (2) this device must accept any interference received, including interference that may cause undesired operation.

Notice: Changes or modification not expressly approved by the party responsible for compliance could void the user's authority to operate the equipment.



For quick touch-ups, try MicroTouch Max!

SONICGROOM[™] by MicroTouch[™]

Quick Start Guide



Thank you for your purchase of the MicroTouch (MT) Sonic Groom. Please follow these simple steps to begin eliminating unwanted hair easily and painlessly!

1. Fully charge unit prior to first use. (It takes approximately 2.5 hours for unit to fully charge)
2. Make sure skin is clean and dry.
3. Turn switch to ON position. Blue touch activated Trimmer Head and green LED will flash.
4. Position the touch activated Trimmer Head against the skin to begin hair removal. (Unit will not operate until it touches skin.)
5. Remove hair by gliding the unit in the opposite direction of hair growth for best results.
6. For shorter hair or stubble, change to Microfoil Shaver.
7. Unit will turn off when not in use. Turn switch to OFF position when finished to save battery.

Distributed by:
idea village[®]

Wayne, NJ 07470
Made in China © 2015 ideavillage
customerservice@ideavillage.com
MTSGIM09142015MW

SONICGROOM[™] by MicroTouch[™]

Contained within the Package



Replacement of Microfoil Shaver and Trimmer Heads

To change / replace heads, place your thumbs on the back of the unit. Push gently in the direction of the arrow, toward the front and in an upward motion. The head will separate from the body. (Image A)

Line up new head with arrow on **back** of unit and press. Head will click into position. (Image B)



Charging the Battery

NOTE: Prior to first use, fully charge MT Sonic Groom for approximately 2.5 hours.

MT Sonic Groom must be charged with the supplied USB cable, using either the supplied AC adapter or an alternate USB source.

While the unit is charging, the red light will remain on.

The green LED will remain on when unit is connected to the adapter and fully charged. Charge will hold approximately 60 minutes run time.

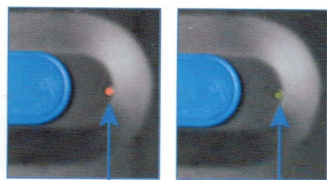

Directions for Use:

Use on clean and completely dry skin with no cream or cosmetic residue.

1. Remove cover (see Image 1).
2. Move switch to ON position (toward head) (see Image 2).
3. Blue touch activated Trimmer Head and green LED will flash (see Image 3).

TRIMMER HEAD

4. Position the touch activated Trimmer Head against the skin to begin hair removal. **This unit will not begin to work until contact has been made with skin.** The blue touch activated Trimmer Head and the green activation LED will remain on while the unit is in use. Place the MT Sonic Groom on skin and gently glide the head of the unit along skin in the opposite direction of hair growth at a 45° angle (**NOT at a 90° angle**) (see Image 4).

DO NOT APPLY EXCESSIVE PRESSURE DURING USE to avoid damage to skin or head of unit. Discontinue use if any skin irritation results.

MICROFOIL SHAVER

5. For short hair, stubble or touch-ups, select the touch activated Microfoil Shaver (see Image 5). For best results while using the Microfoil Shaver, hold the MT Sonic Groom at a 90° angle to skin (**NOT on a 45° angle**) and apply SLIGHT pressure (see Image 6).

NOTE: For more effective hair removal, make sure to trim hair as short as possible using the Trimmer Head prior to using the Microfoil Shaver.

6. MT Sonic Groom will turn off within approximately 6 seconds. Green LED will return to flash. Unit will automatically turn on again when it comes in contact with skin.

7. When finished using your MT Sonic Groom, turn switch to OFF position (away from head), cover and store in cool dry place.

GROOMING GUIDE ATTACHMENTS

8. Included with MT Sonic Groom are three Grooming Guide attachments for use over the Trimmer Head. Determine which attachment will meet your desired length.

Smallest Grooming Guide

9. The smallest Grooming Guide attachment is recommended for beards and goatees (approximately 1/8"). When trimming beard or goatee, lay edge of Grooming Guide against the skin or at a 45° angle, depending on preferred length.

Medium Grooming Guide

10. The medium Grooming Guide attachment will provide a close trim (approximately 3/16").

Largest Grooming Guide

11. The largest Grooming Guide attachment (approximately 3/8") is better if you are looking for a longer look. When trimming hair, the edge of the Grooming Guide (see Image 7) should be against your head, running the unit in the direction of hair.

NOTE: Grooming Guide attachments are not touch activated. Unit will stay on once the Grooming Guide attachment is in place and power switch is turned on.

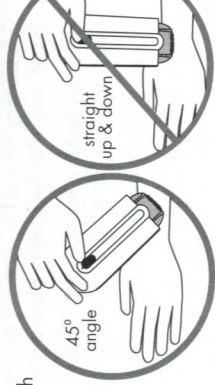
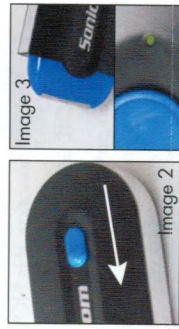

Image 4

Usage for touch activated Trimmer Head



Image 5

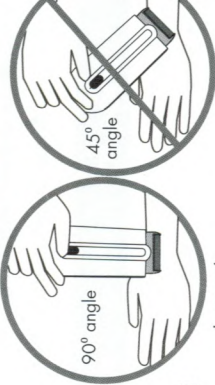

Image 6

Usage for Microfoil Shaver



Image 7

IMPORTANT SAFETY INSTRUCTIONS - SAVE THESE INSTRUCTIONS

DANGER: TO REDUCE THE RISK OF FIRE OR ELECTRIC SHOCK, CAREFULLY FOLLOW THESE INSTRUCTIONS. FOR CONNECTION TO A SUPPLY NOT IN THE U.S.A., USE AN ATTACHMENT PLUG ADAPTER OF THE PROPER CONFIGURATION FOR THE POWER OUTLET.